

EN SIDE STEP PROTECTION INSTALLATION MANUAL

DE MONTAGEEINLEITUNG FÜR SEITENSTUFENSCHUTZ

RU ИНСТРУКЦИЯ ПО УСТАНОВКЕ
КОМПЛЕКТА ЗАЩИТЫ ПОРОГОВ



For: Yamaha Wolverine RMAX2 1000 (2021-2022)

2444.7184.1



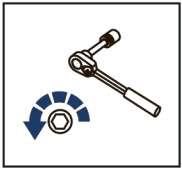

EN Regular fasteners
DE Originale montageteile
RU Штатный крепеж

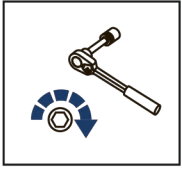

EN Regular fasteners
DE Originale montageteile
RU Штатный крепеж



EN Screw a several turns
DE Für wenigen Umdrehungen befestigen
RU Вкрутить на несколько оборотов

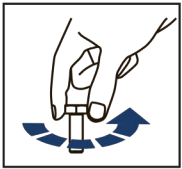

EN Loosen bolts
DE Bolzen lockern
RU Выкрутить на несколько оборотов

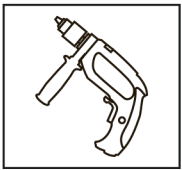

EN Drill
DE Bohrer
RU Дрель

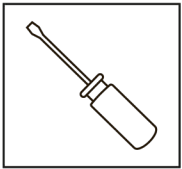

EN Screwdriver
DE Schraubenzieher
RU Отвертка

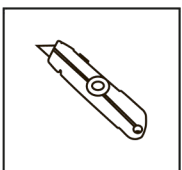

EN Office Knife
DE Büromesser
RU Канцелярский нож

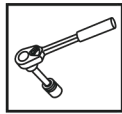



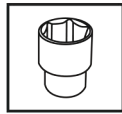

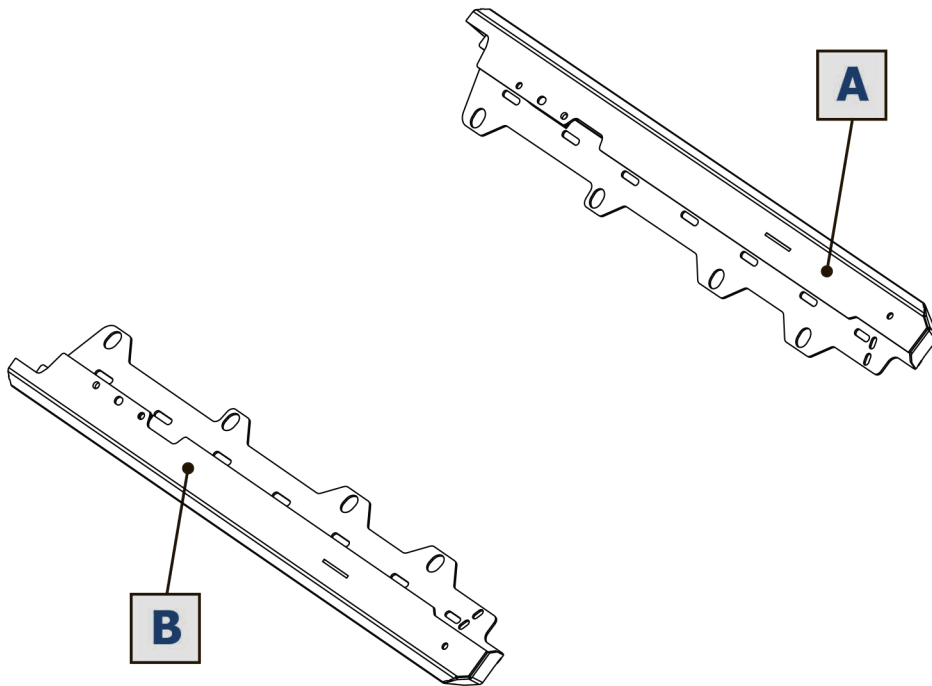

EN Ratchet
RU Трещётка

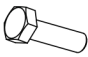

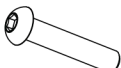
S - 10;
S - 14;
S - 17;
S - 19

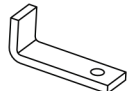
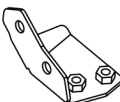

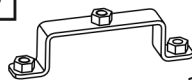
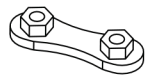
1  M8x20 x16	2  M8x25 x6	3  M8x40 x2	4  ø8 x14	5  ø8 x8	6  M8x50 x8
7  x1	8  x1	9  x2	10  x2		

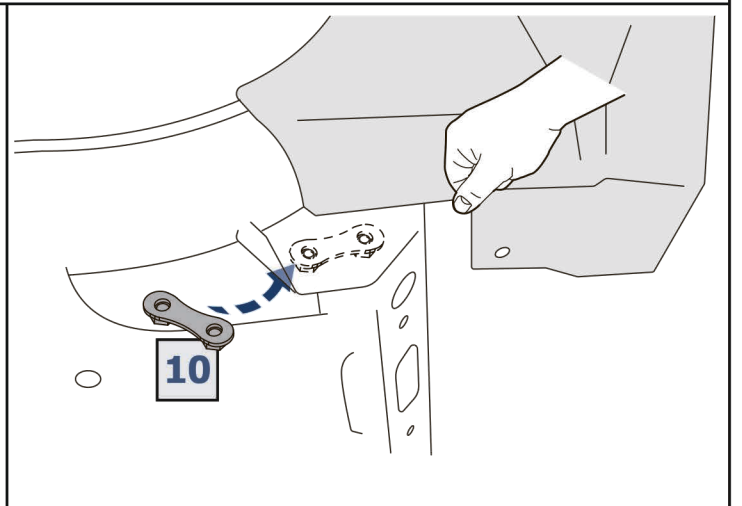
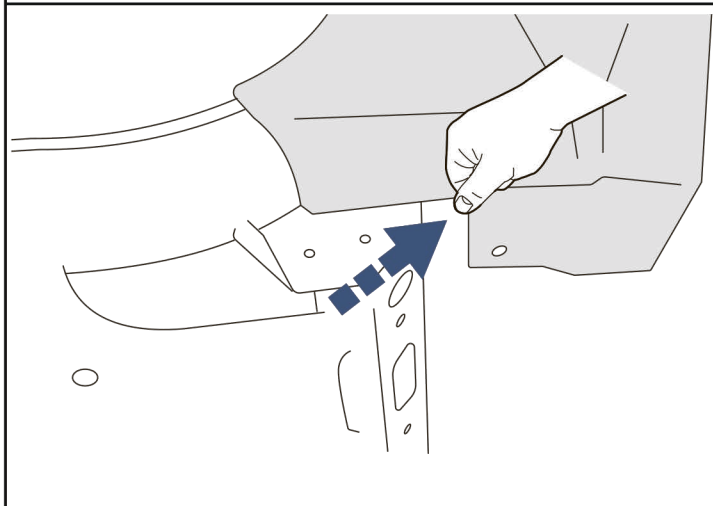
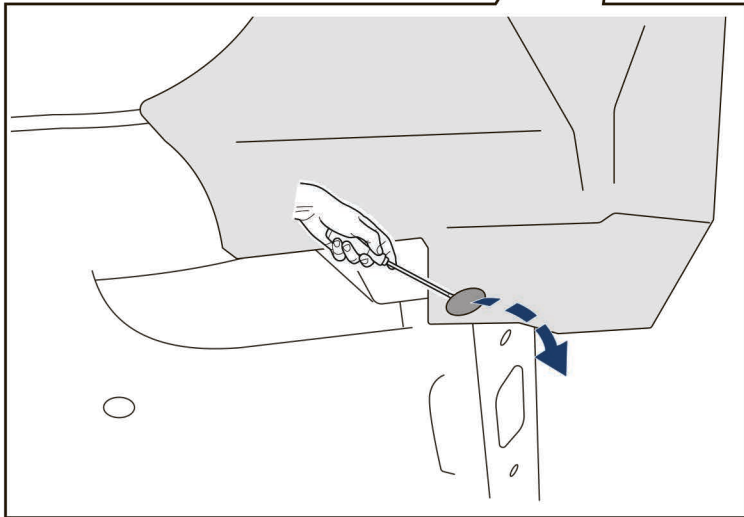
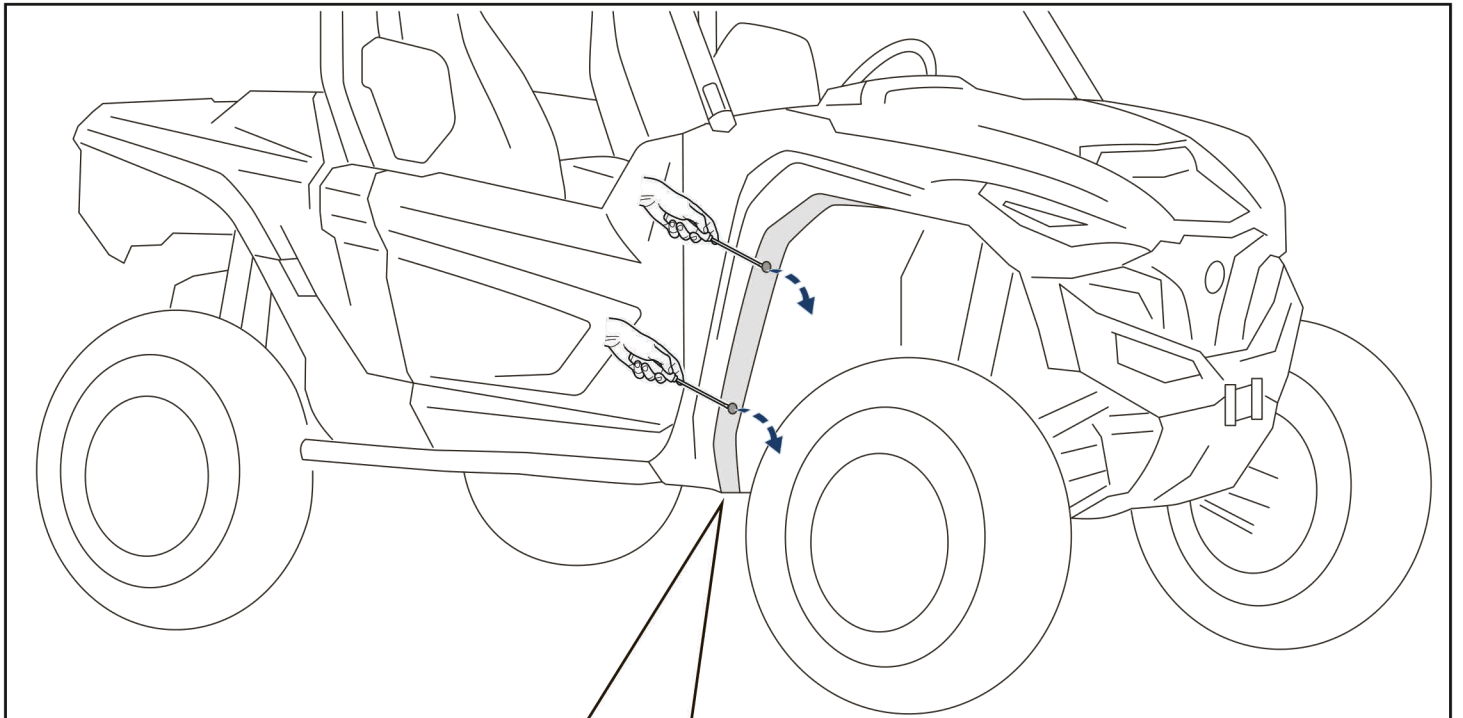

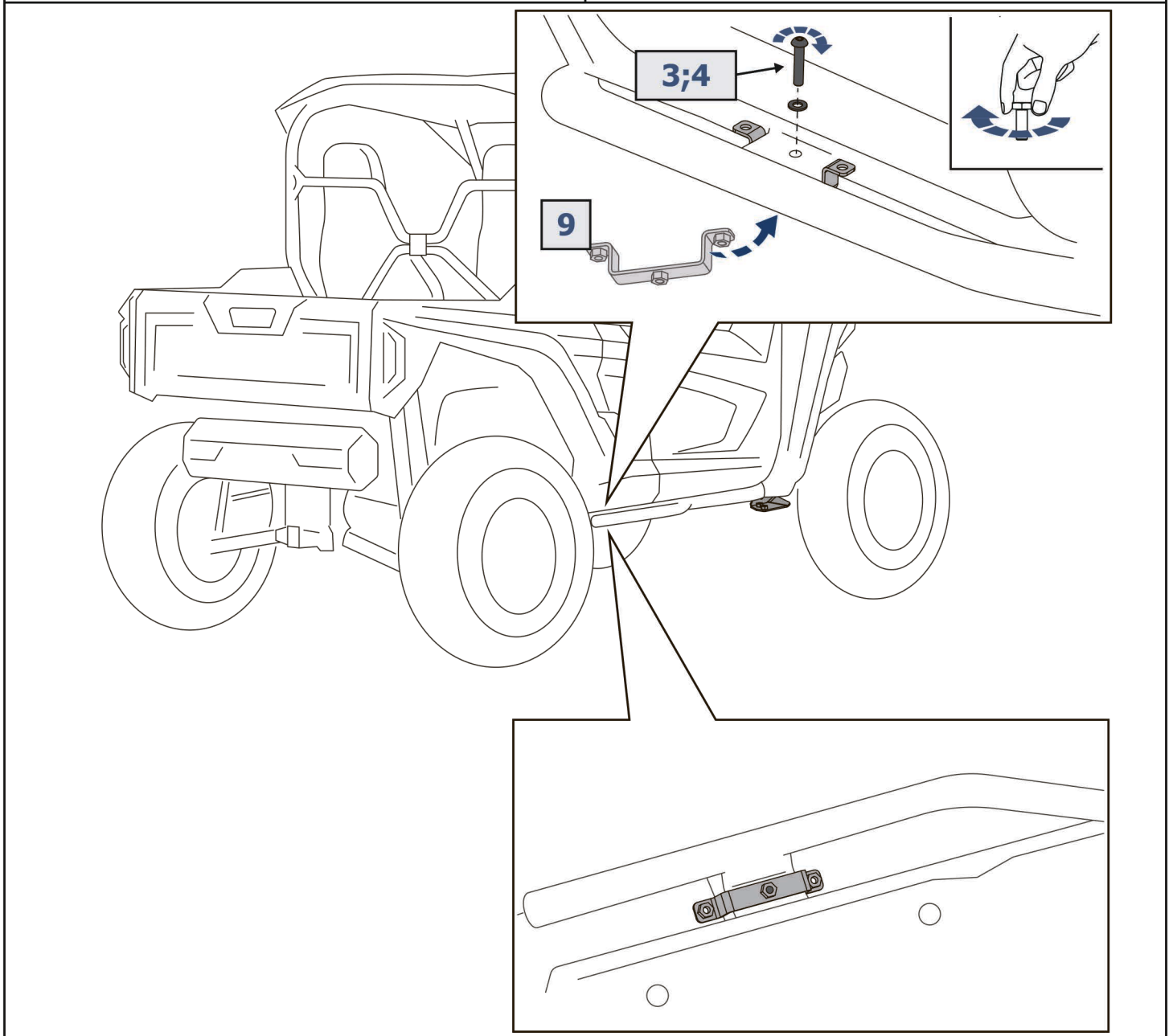
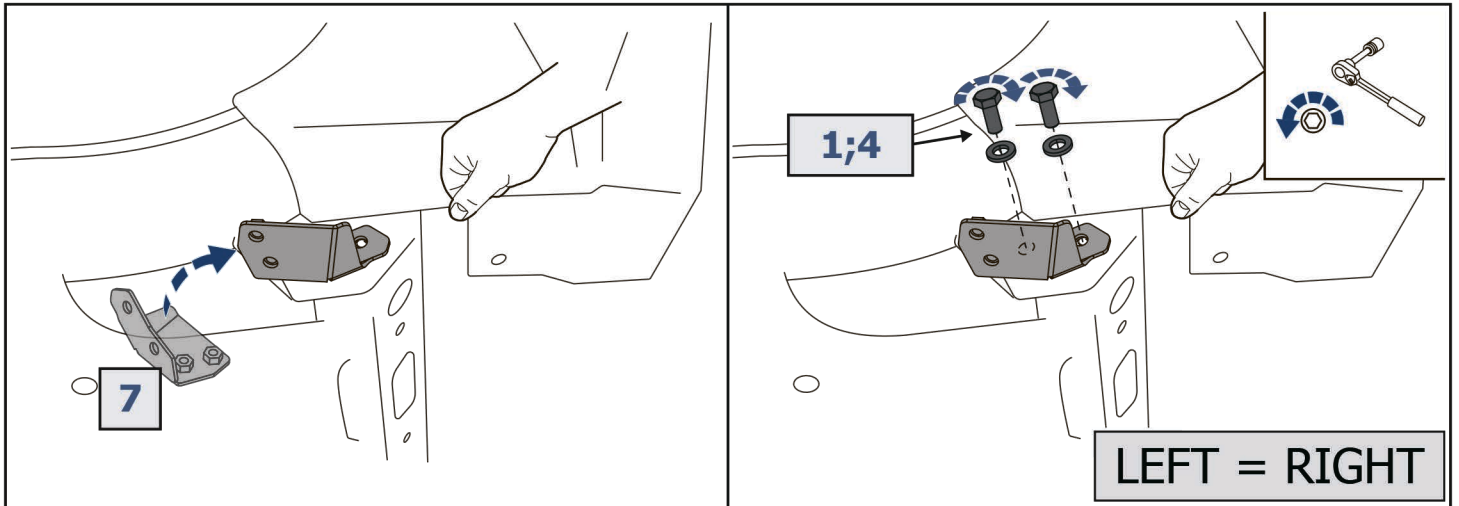

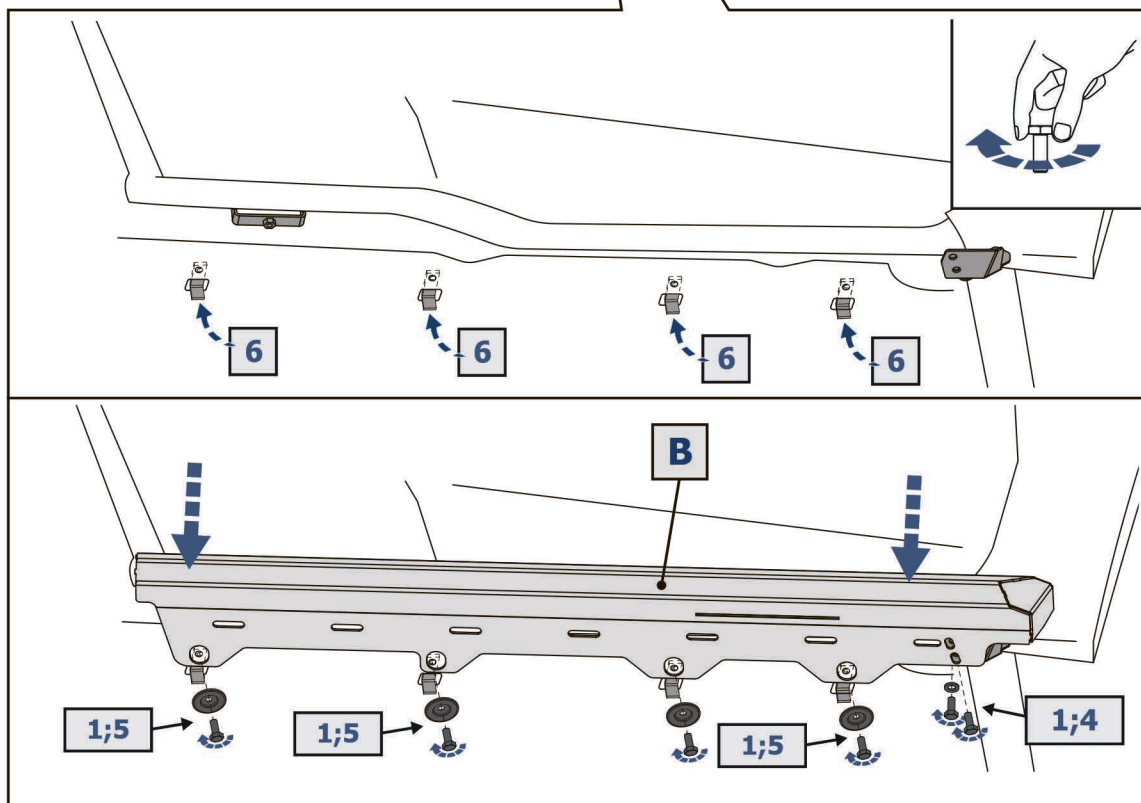
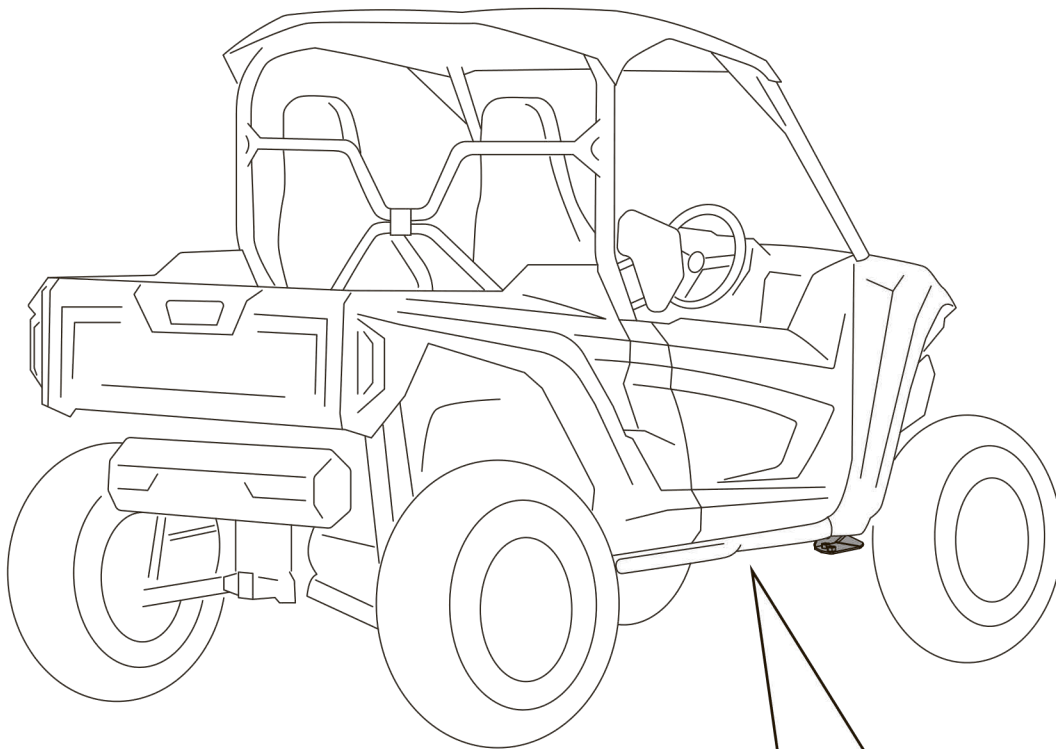

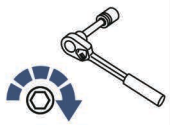

M8=24 Nm

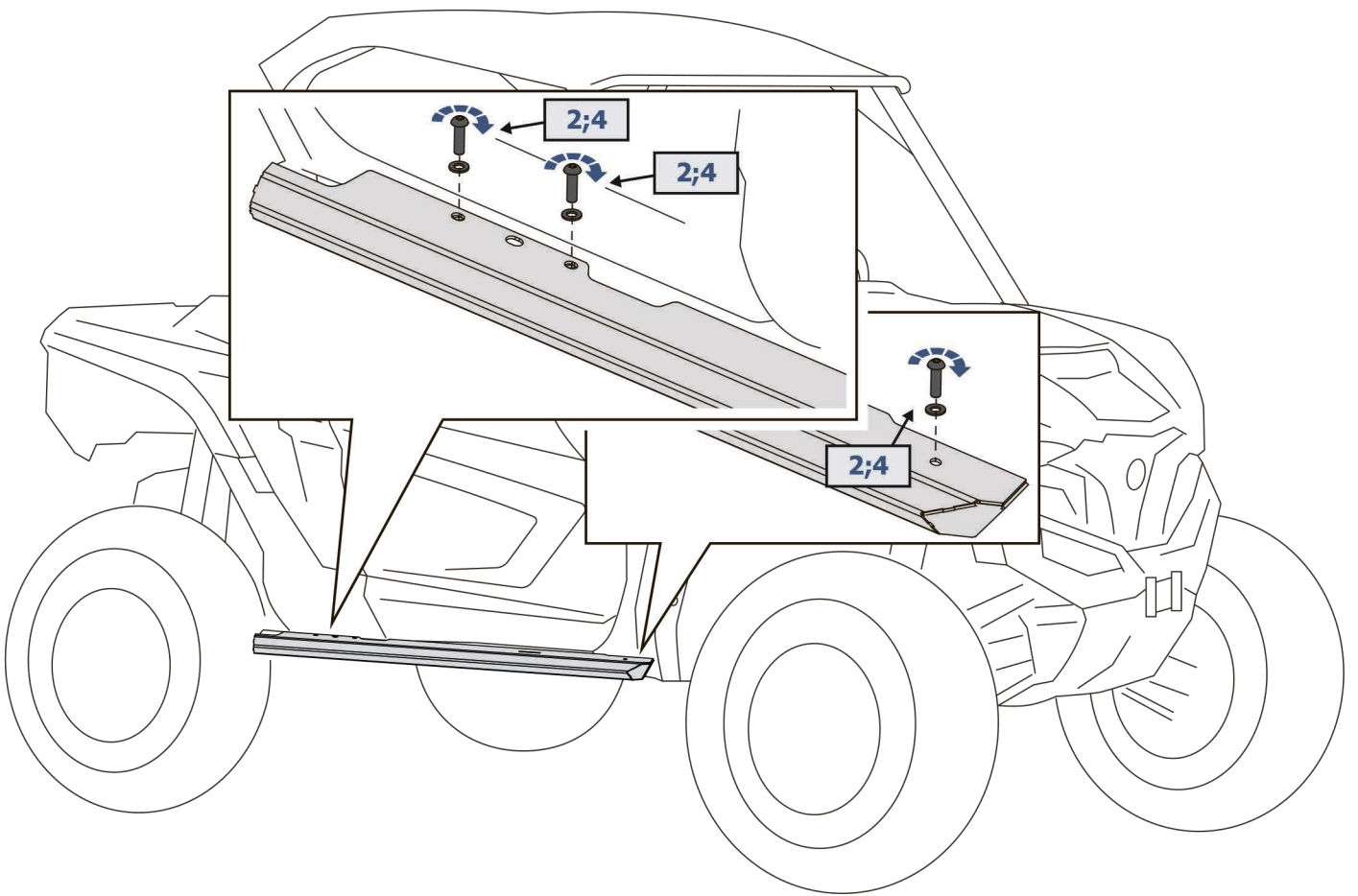

LEFT = RIGHT

